

Technical Data Sheet

STRAUB-PLAST-PRO B90

ELBOW 90°

Components	Materials
Shells	AISI 316 L or similar
Bolts	A4 - 80
Bars	AISI 316 L
Liner insert	Carbon steel, Rilsan coated (W270, NSF61, WRAS)
Medium	all qualities of water
Temperature	-5°C up to 40°C 6

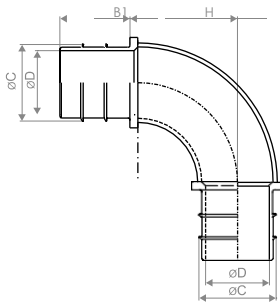

up to 110 mm: for PN 16 pipes 6
 from 125 mm: for PN 16 and PN 10 pipes 6
 > 180 mm: for PN 10 pipes 6

SDR 11

OD [mm]	DIN 3	Article multilayer	B1 [mm]	C [mm]	D [mm]	H [mm]	Weight [kg]
63.0	870520	870450	45.0	49.5	41.0	69.0	2.0
75.0	870525	870455 2	45.0	59.5	50.5	77.0	2.3
90.0	870530	870460	45.0	71.0	62.0	97.0	3.2
110.0	870535	870465	52.5	87.5	76.0	122.0	3.7
125.0	870539	870469	52.5	99.5	86.5	138.0	6.1
140.0	870544	870474 2	52.5	111.5	97.5	147.0	6.9
160.0	870549	870479	52.5	127.5	113.5	180.0	9.3
180.0	870554	870484	52.5	143.5	126.5	200.0	10.6

SDR 17

OD [mm]	DIN 3	Article multilayer	B1 [mm]	C [mm]	D [mm]	H [mm]	Weight [kg]
90.0	870531	870461	45.0	77.0	66.8	100.0	3.3
110.0	870536	870466	52.5	94.5	82.3	122.0	3.8
125.0	870540	870470	52.5	108.0	95.0	147.0	6.0
140.0	870545	870475 2	52.5	121.0	107.0	157.0	7.1
160.0	870550	870480	52.5	138.5	124.5	195.0	8.3
180.0	870555	870485	52.5	156.0	139.0	226.0	10.8
225.0	870495 2	870495 2	52.5	195.0	173.0	280.0	19.6
250.0	870500 2	870500 2	52.5	217.0	193.0	325.0	26.0
280.0	870505 2	870505 2	52.5	243.0	217.0	398.0	37.0
315.0	870510 2	870510 2	52.5	273.0	243.0	401.0	44.5
355.0	870515 2	870515 2	52.5	308.0	274.0	477.0	63.2