

Technical Data Sheet

STRAUB-PLAST-PRO T

EQUAL TEE

Components	Materials
Shells	AISI 316 L or similar
Bolts	A4 - 80
Bars	AISI 316 L
Liner insert	Carbon steel, Rilsan coated (W270, NSF61, WRAS)
Medium	all qualities of water
Temperature	-5°C up to 40°C 6

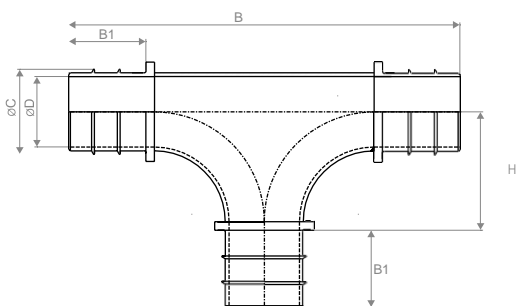

up to 110 mm: for PN 16 pipes 6
 from 125 mm: for PN 16 and PN 10 pipes 6
 > 180 mm: for PN 10 pipes 6



SDR 11

OD [mm]	Article		B [mm]	B1 [mm]	C [mm]	D [mm]	H [mm]	Weight [kg]
	DIN 3	multilayer						
63.0	870370	870300	214.0	45.0	49.5	41.0	62.0	3.0
75.0	870375	870305 ²	228.0	45.0	59.5	50.5	69.0	4.0
90.0	870380	870310	252.0	45.0	71.0	62.0	81.0	5.3
110.0	870385	870315	287.0	52.5	87.5	76.0	91.0	7.4
125.0	870389	870319	315.0	52.5	99.5	86.5	105.0	7.5
140.0	870394	870324 ²	315.0	52.5	111.5	97.5	105.0	8.2
160.0	870399	870329	355.0	52.5	127.5	113.5	125.0	11.6
180.0	870404	870334	363.0	52.5	143.5	126.5	129.0	12.2

SDR 17

OD [mm]	Article		B [mm]	B1 [mm]	C [mm]	D [mm]	H [mm]	Weight [kg]
	DIN 3	multilayer						
90.0	870381	870311	252.0	45.0	77.0	66.8	81.0	5.4
110.0	870386	870316	287.0	52.5	94.5	82.3	91.0	7.5
125.0	870390	870320	325.0	52.5	108.0	95.0	110.0	8.9
140.0	870395	870325 ²	325.0	52.5	121.0	107.0	110.0	12.5
160.0	870400	870330	363.0	52.5	138.5	124.5	129.0	16.1
180.0	870405	870335	401.0	52.5	156.0	139.0	148.0	19.0
225.0	870345 ²	870345 ²	401.0	52.5	195.0	173.0	148.0	20.1
250.0	870350 ²	870350 ²	471.0	52.5	217.0	193.0	183.0	24.5
280.0	870355 ²	870355 ²	471.0	52.5	243.0	217.0	183.0	28.6
315.0	870360 ²	870360 ²	547.0	52.5	273.0	243.0	221.0	44.4
355.0	870365 ²	870365 ²	623.0	52.5	308.0	274.0	259.0	53.8